

SCHEDULE B
ZONING BYLAW NO. 506, 1986
OFFICIAL ZONING MAP
CHETWYND RURAL AREA

1. THIS IS SCHEDULE B OF BYLAW No. 506, 1986 BEING THE OFFICIAL ZONING MAP REFERRED TO IN SECTION 5.2 OF THE SAID BYLAW AND FORMING PART OF THE PEACE RIVER-LIARD REGIONAL DISTRICT ZONING BYLAW No. 506, 1986.

2. SCHEDULE B CONSISTS OF THE FOLLOWING MAPS:

MAP 1	CHETWYND RURAL AREA OFFICIAL ZONING MAP
MAP 2	WABI HILL
MAP 3	DOKIE - WILDMARE
MAP 4	JACKFISH LAKE
MAP 5	MOBERLY LAKE
MAP 6	HASLER FLATS
MAP 7	WILLOW FLATS
MAP 8	EAST PINE

SCHEDULE B
ZONING BYLAW No. 506, 1988
OFFICIAL ZONING MAP
CHETWYND RURAL AREA

This is Schedule B of Bylaw No. 506, 1988, Being the Official Zoning Map Referred to in Section 82 of the Solid Waste and Farming Part of the Peace River-Liard Regional District Zoning Bylaw No. 506, 1988.

[Signature]
 SECRETARY

Map 1
Chetwynd Rural Area
Official Zoning Map

ZONES

Convenient Reference	Correct Name
A-1	SMALL AGRICULTURAL HOLDINGS ZONE - 15 ha
A-2	LARGE AGRICULTURAL HOLDINGS ZONE - 63 ha
CR	COUNTRY RESIDENTIAL ZONE - 1.0 ha
RR-1	RURAL RESIDENTIAL ZONE - 1.0 ha
RR-2	RURAL RESIDENTIAL ZONE - 4.0 ha
RR-4	SMALL HOLDINGS ZONE - 8.0 ha
R-1	RESIDENTIAL ZONE
R-2	SEMI-RURAL RESIDENTIAL ZONE
R-3	MOBILE HOME PARK RESIDENTIAL ZONE
MU-R	MIXED USE - RESIDENTIAL ZONE
C-1	LOCAL COMMERCIAL ZONE
C-2	HIGHWAY COMMERCIAL ZONE
C-5	RECREATIONAL COMMERCIAL ZONE
M-1	LIGHT INDUSTRIAL ZONE
M-2	GENERAL INDUSTRIAL ZONE
P-1	PUBLIC SERVICE ZONE
P-2	INSTITUTIONAL ZONE
■■■■	ZONING BYLAW No. 506, 1988 BOUNDARY

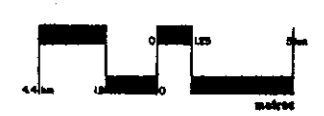

Amended to:
 Bylaw No. 1988

Peace River Liard
 Regional District

Bylaw No. 533, 1989
 Bylaw No. 821, 1992

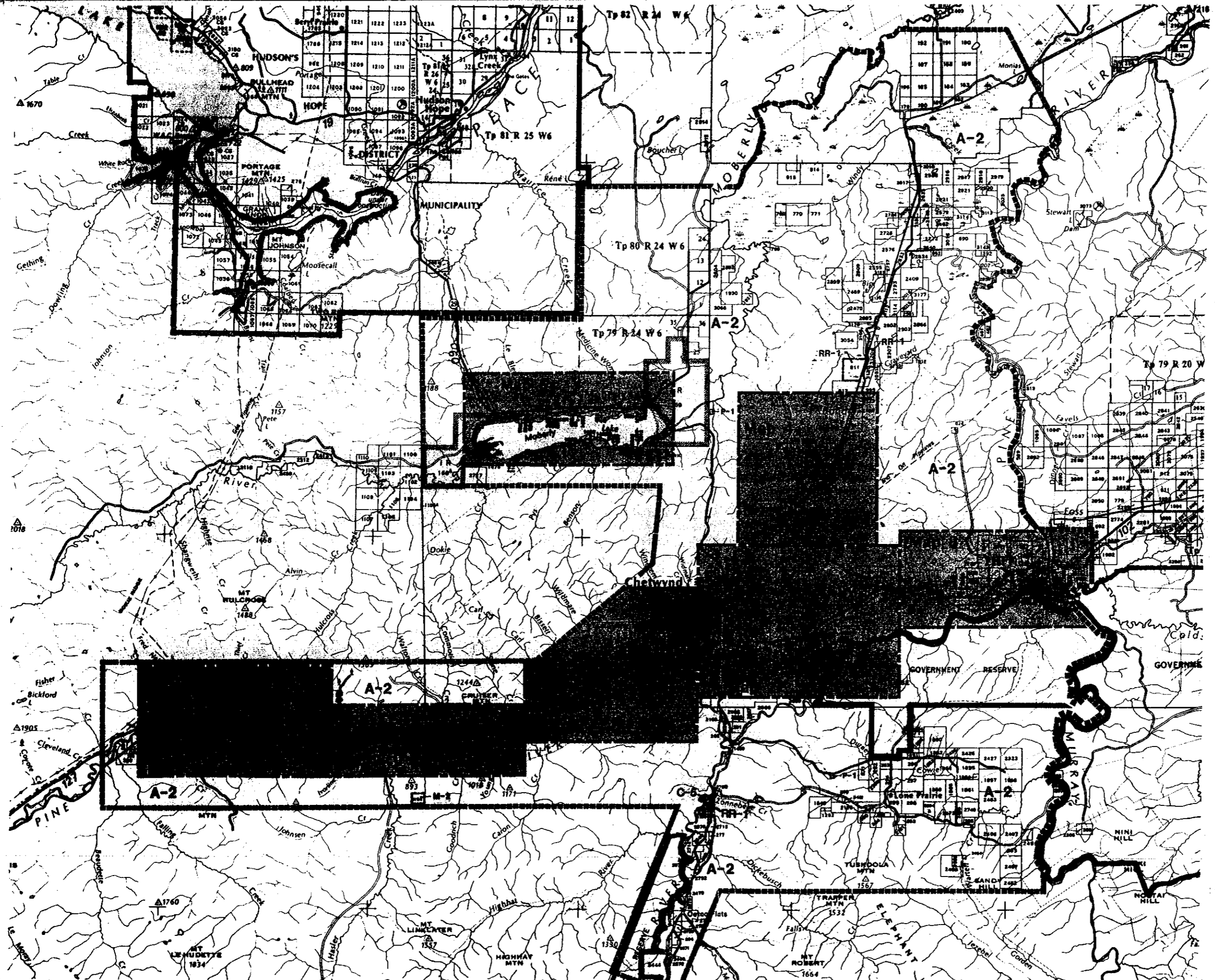

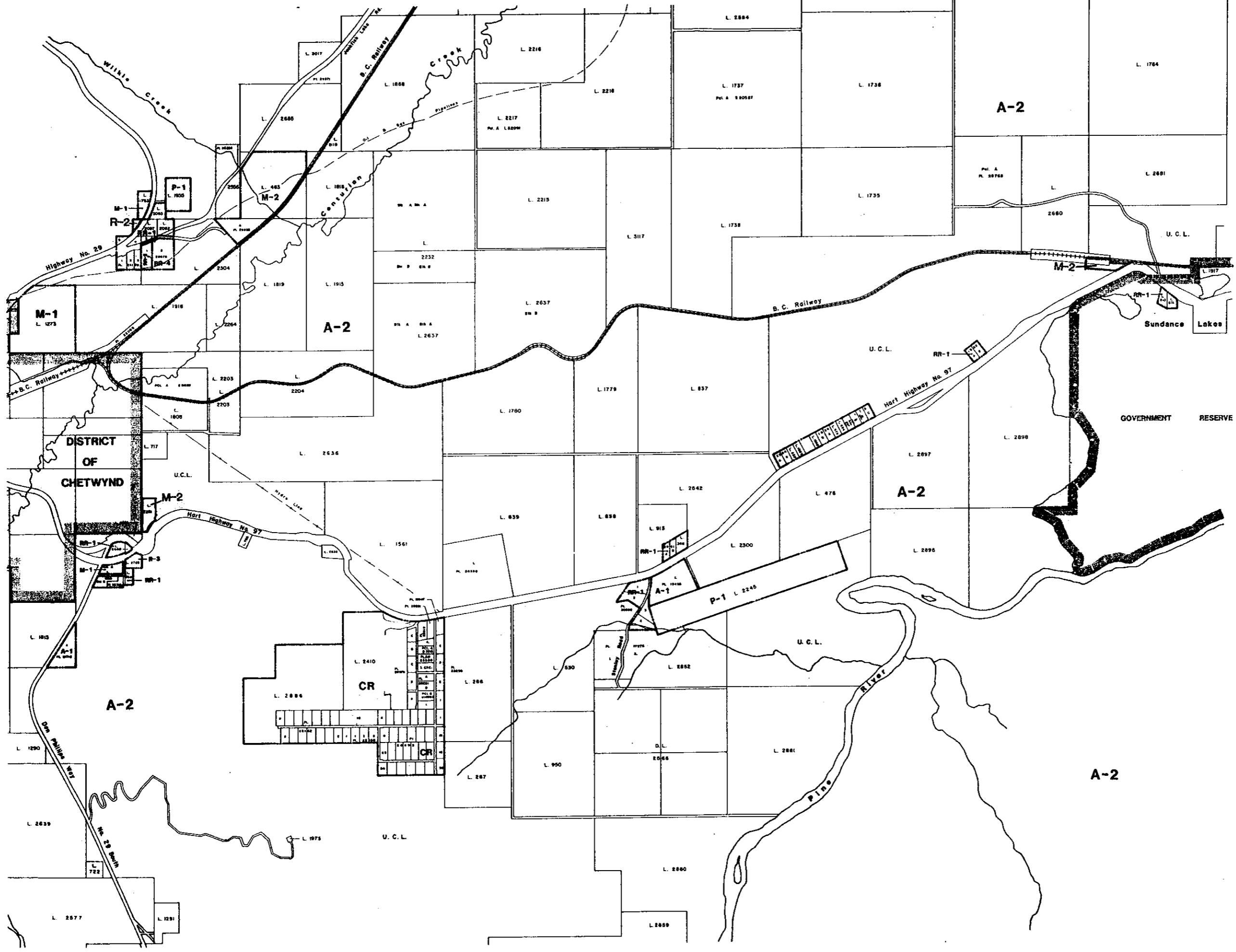

SCHEDULE B
ZONING BYLAW No. 506, 1986
OFFICIAL ZONING MAP
CHETWYND RURAL AREA

This is Schedule B of Bylaw No. 506, 1986, being the Official Zoning Map Referred to in Section 52 of the said Bylaw and Forming Part of the Peace River-Liard Regional District Zoning Bylaw No. 506, 1986.

[Signature]
 SECRETARY

Map 2
Wabi Hill

ZONES

Convenient Reference	Correct Name
A-1	SMALL AGRICULTURAL HOLDINGS ZONE - 15 ha
A-2	LARGE AGRICULTURAL HOLDINGS ZONE - 63 ha
CR	COUNTRY RESIDENTIAL ZONE - 1.8 ha
RR-1	RURAL RESIDENTIAL ZONE - 1.8 ha
RR-2	RURAL RESIDENTIAL ZONE - 4.0 ha
RR-4	SMALL HOLDINGS ZONE - 8.0 ha
R-1	RESIDENTIAL ZONE
R-2	SEMI-RURAL RESIDENTIAL ZONE
R-3	MOBILE HOME PARK RESIDENTIAL ZONE
MU-R	MIXED USE - RESIDENTIAL ZONE
C-1	LOCAL COMMERCIAL ZONE
C-2	HIGHWAY COMMERCIAL ZONE
C-3	RECREATIONAL COMMERCIAL ZONE
M-1	LIGHT INDUSTRIAL ZONE
M-2	GENERAL INDUSTRIAL ZONE
P-1	PUBLIC SERVICE ZONE
P-2	INSTITUTIONAL ZONE

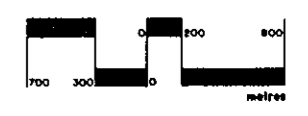

Amended to
 Bylaw No. 539, 539, 1987
 Law No. 657, 1990

Peace
 Regional District

SCHEDULE B
ZONING BYLAW No. 506, 1986
OFFICIAL ZONING MAP
CHETWYND RURAL AREA

This is Schedule B of Bylaw No. 506, 1986, Being the Official Zoning Map Referred to in Section 5.2 of the said Bylaw and Forming Part of the Peace River-Liard Regional District Zoning Bylaw No. 506, 1986.

[Signature]
 SECRETARY

Map 3
Dokie - Wildmare

ZONES

Convenient Reference	Correct Name
A-1	SMALL AGRICULTURAL HOLDINGS ZONE - 15 ha
A-2	LARGE AGRICULTURAL HOLDINGS ZONE - 65 ha
CR	COUNTRY RESIDENTIAL ZONE - 1.8 ha
RR-1	RURAL RESIDENTIAL ZONE - 1.8 ha
RR-2	RURAL RESIDENTIAL ZONE - 4.0 ha
RR-4	SMALL HOLDINGS ZONE - 8.0 ha
R-1	RESIDENTIAL ZONE
R-2	SEMI-RURAL RESIDENTIAL ZONE
R-3	MOBILE HOME PARK RESIDENTIAL ZONE
MU-R	MIXED USE - RESIDENTIAL ZONE
C-1	LOCAL COMMERCIAL ZONE
C-2	HIGHWAY COMMERCIAL ZONE
C-5	RECREATIONAL COMMERCIAL ZONE
M-1	LIGHT INDUSTRIAL ZONE
M-2	GENERAL INDUSTRIAL ZONE
P-1	PUBLIC SERVICE ZONE
P-2	INSTITUTIONAL ZONE
	ZONING MAP BOUNDARY



Bylaw No. 616, 1989
 Bylaw No. 755, 1991

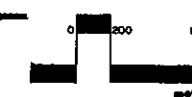

Amended to:
 Bylaw No. 1985

Peace River Liard
 Regional District

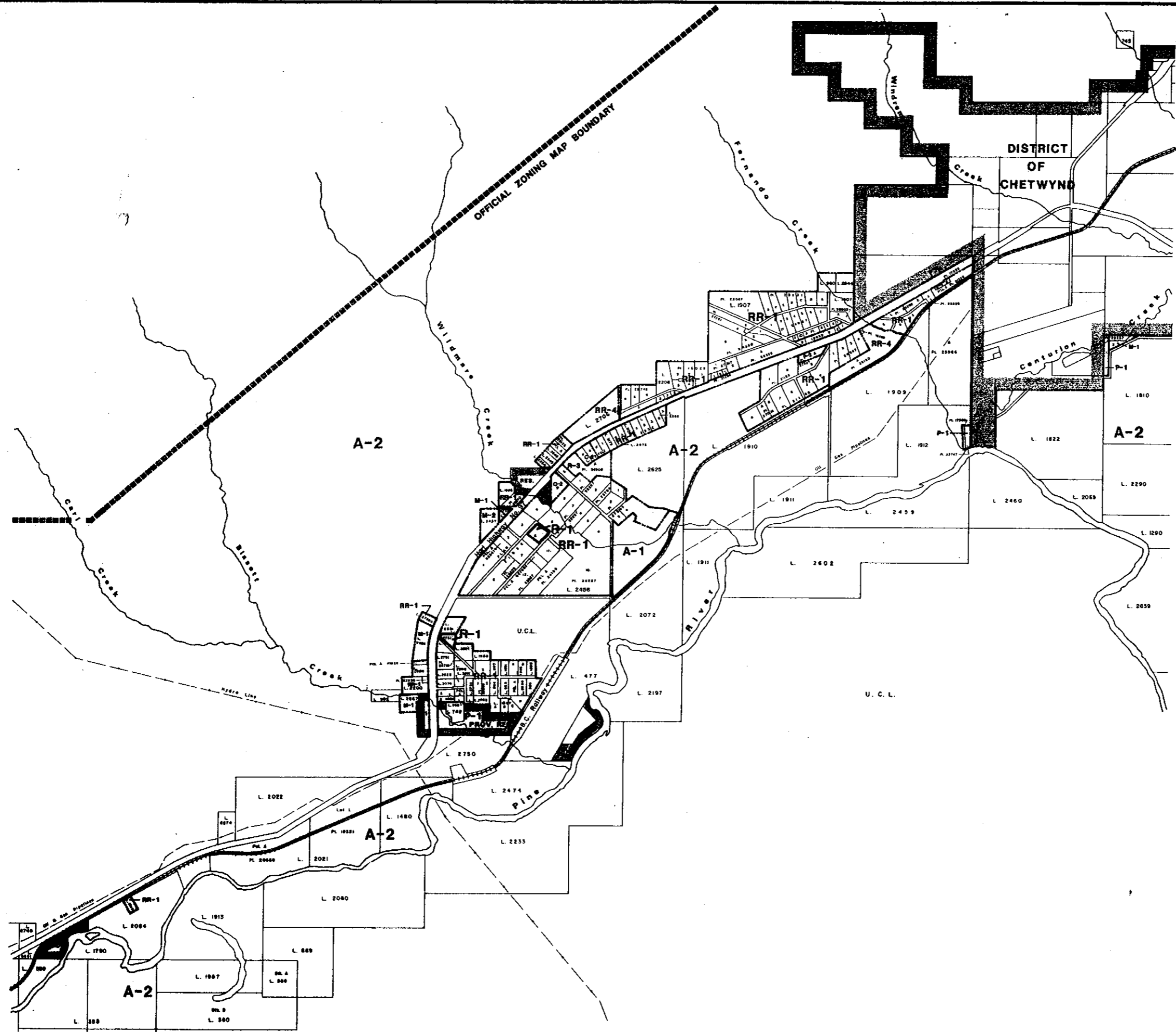

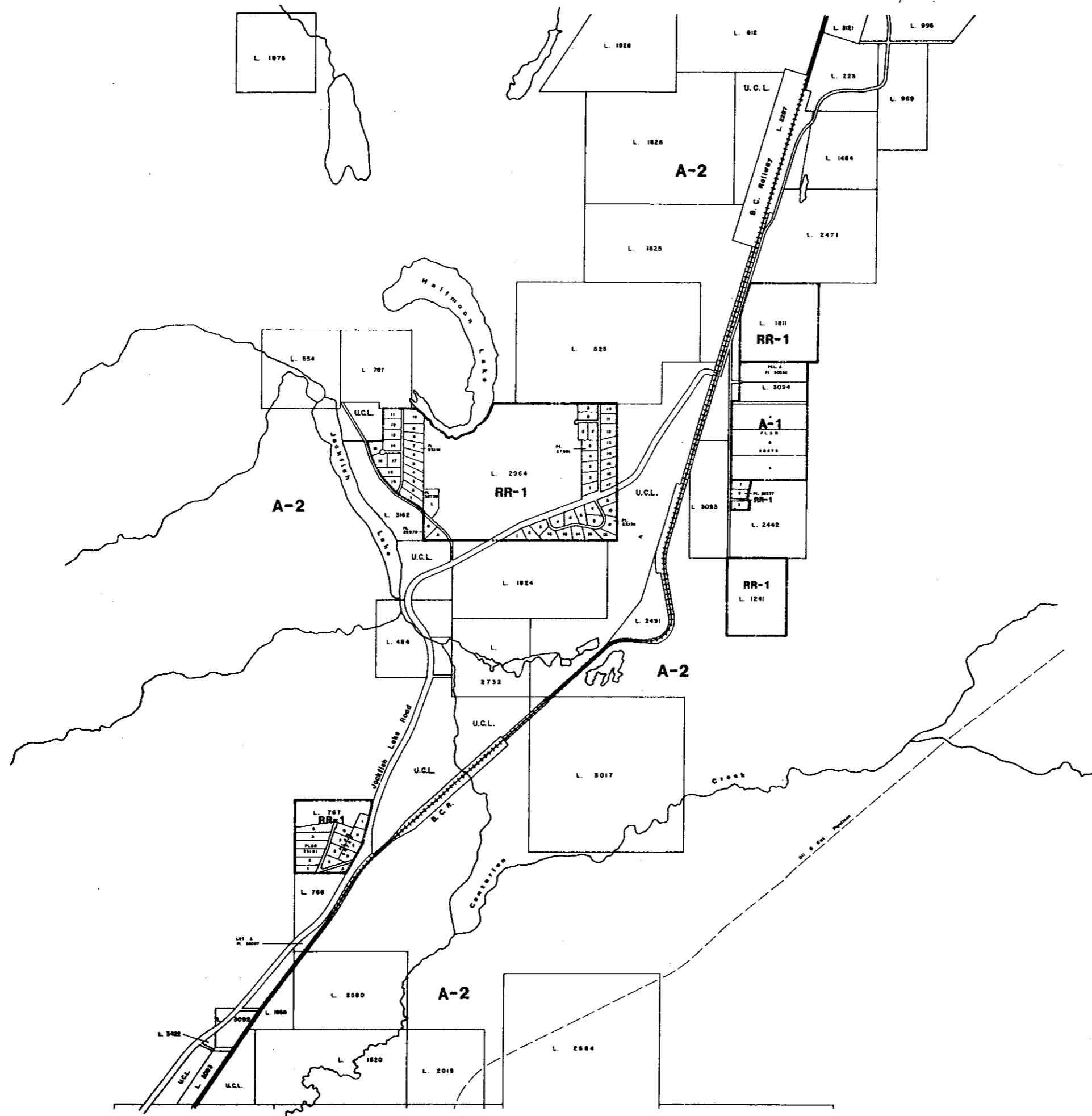

SCHEDULE B
ZONING BYLAW No. 506, 1986
OFFICIAL ZONING MAP
CHETWYND RURAL AREA

This is Schedule B of Bylaw No. 506, 1986,
 Being the Official Zoning Map Referred to
 in Section 52 of the said Bylaw and
 Forming Part of the Peace River-Liard
 Regional District Zoning Bylaw No. 506, 1986.

[Signature]
 SECRETARY

Map 4
Jackfish Lake

ZONES

Convenient Reference	Correct Name
A-1	SMALL AGRICULTURAL HOLDINGS ZONE - 15 ha
A-2	LARGE AGRICULTURAL HOLDINGS ZONE - 63 ha
CR	COUNTRY RESIDENTIAL ZONE - 1.8 ha
RR-1	RURAL RESIDENTIAL ZONE - 1.8 ha
RR-2	RURAL RESIDENTIAL ZONE - 4.0 ha
RR-4	SMALL HOLDINGS ZONE - 8.0 ha
R-1	RESIDENTIAL ZONE
R-2	SEMI-RURAL RESIDENTIAL ZONE
R-3	MOBILE HOME PARK RESIDENTIAL ZONE
MU-R	MIXED USE - RESIDENTIAL ZONE
C-1	LOCAL COMMERCIAL ZONE
C-2	HIGHWAY COMMERCIAL ZONE
C-3	RECREATIONAL COMMERCIAL ZONE
M-1	LIGHT INDUSTRIAL ZONE
M-2	GENERAL INDUSTRIAL ZONE
P-1	PUBLIC SERVICE ZONE
P-2	INSTITUTIONAL ZONE



Amended to
 Bylaw No. 1985

Peace River Liard
 Regional District

SCHEDULE B
ZONING BYLAW No. 506, 1966
OFFICIAL ZONING MAP
CHETWYND RURAL AREA

This is Schedule B of Bylaw No. 506, 1966, Being the Official Zoning Map Referred to in Section 5.2 of the said Bylaw and Forming Part of the Peace River-Liard Regional District Zoning Bylaw No. 506, 1966.

[Signature]
 SECRETARY

Map 5
Moberly Lake

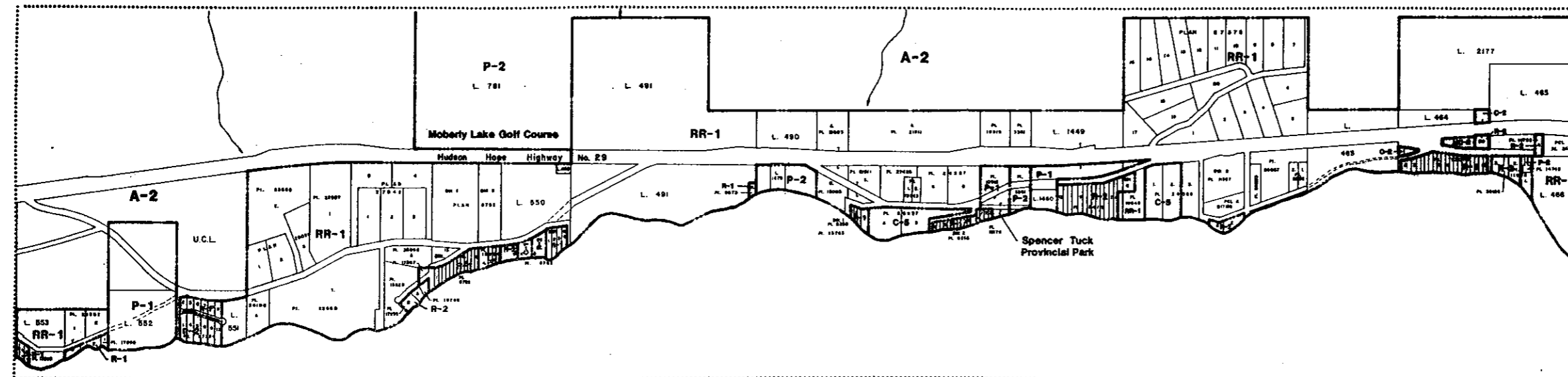

Detail Map 5-1 scale 1:10,000

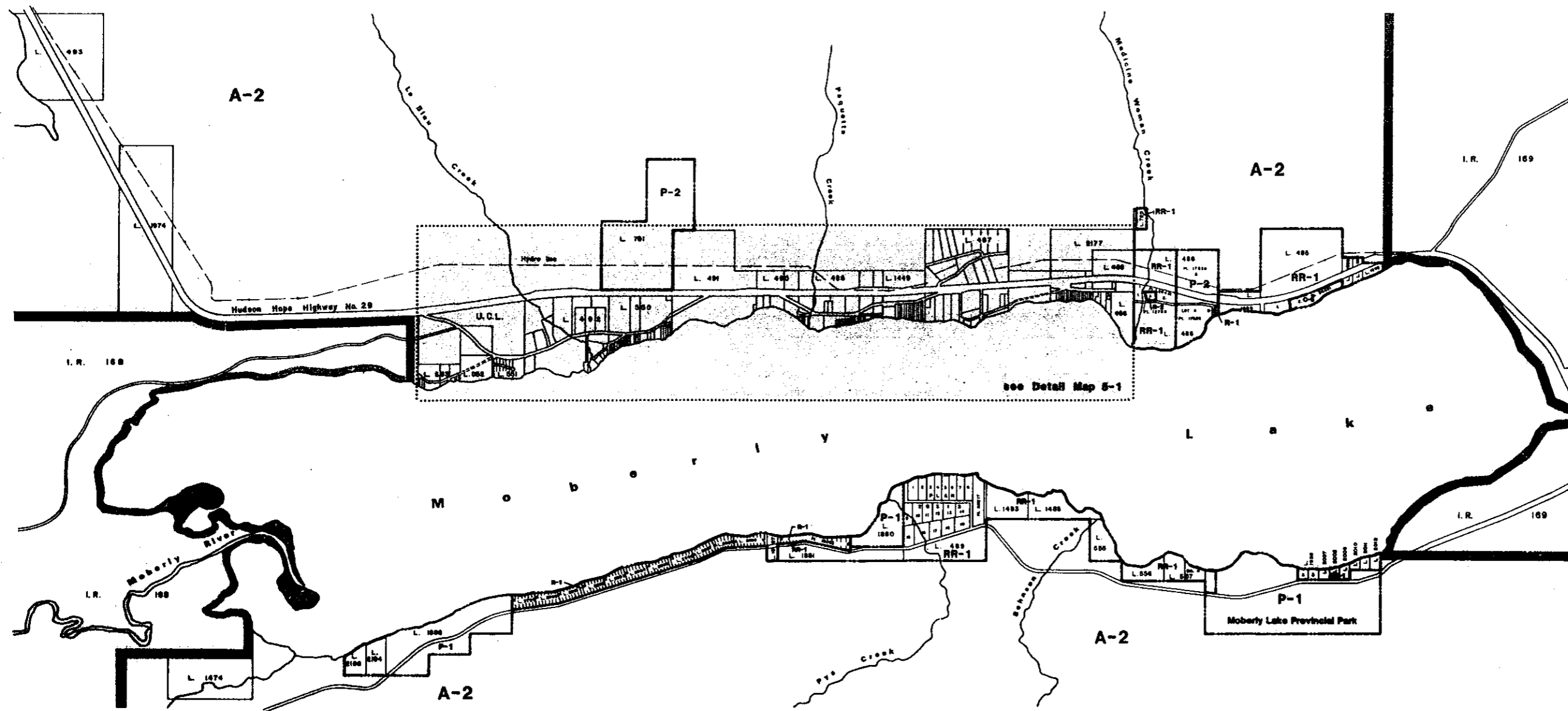

ZONES

Convenient Reference	Correct Name
A-1	SMALL AGRICULTURAL HOLDINGS ZONE - 15 ha
A-2	LARGE AGRICULTURAL HOLDINGS ZONE - 63 ha
CR	COUNTRY RESIDENTIAL ZONE - 1.8 ha
RR-1	RURAL RESIDENTIAL ZONE - 1.8 ha
RR-2	RURAL RESIDENTIAL ZONE - 4.0 ha
RR-4	SMALL HOLDINGS ZONE - 8.0 ha
R-1	RESIDENTIAL ZONE
R-2	SEMI-RURAL RESIDENTIAL ZONE
R-3	MOBILE HOME PARK RESIDENTIAL ZONE
MU-R	MIXED USE - RESIDENTIAL ZONE
C-1	LOCAL COMMERCIAL ZONE
C-2	HIGHWAY COMMERCIAL ZONE
C-6	RECREATIONAL COMMERCIAL ZONE
M-1	LIGHT INDUSTRIAL ZONE
M-2	GENERAL INDUSTRIAL ZONE
P-1	PUBLIC SERVICE ZONE
P-2	INSTITUTIONAL ZONE

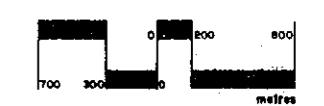

Amended to:
 Bylaw No. 1965

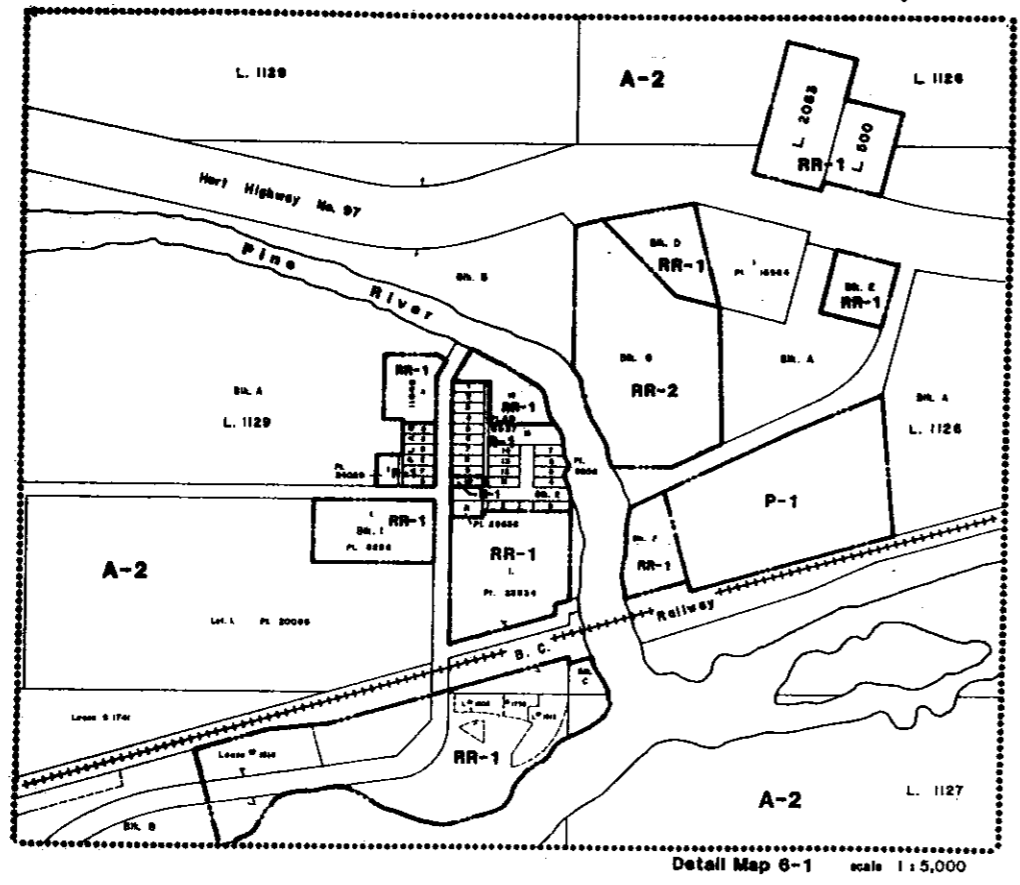

Detail Map 6-1 scale 1:5,000

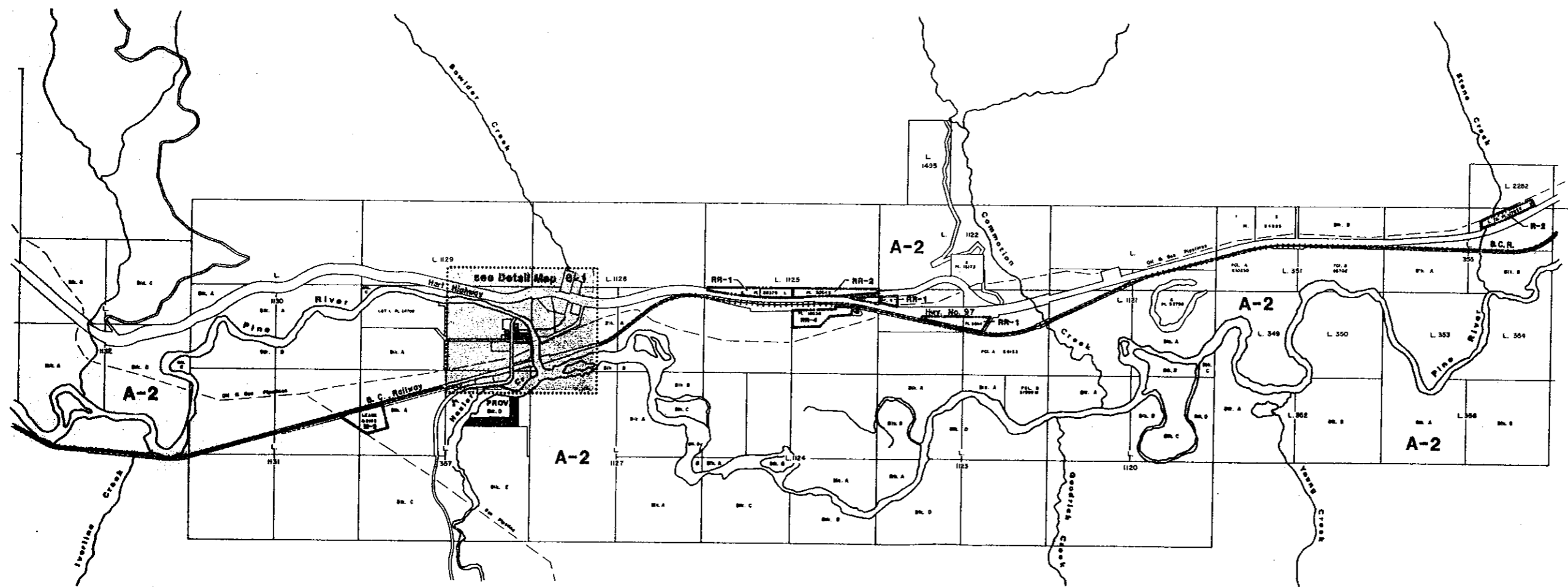

SCHEDULE B
ZONING BYLAW No. 505, 1985
OFFICIAL ZONING MAP
CHETWYND RURAL AREA

This is Schedule B of Bylaw No. 505, 1985, being the Official Zoning Map referred to in Section 6.2 of the Peace River-Liard Regional District Zoning Bylaw No. 505, 1985.

[Signature]
 SECRETARY

Map 6
Hasler Flats

ZONES

Convenient Reference	Correct Name
A-1	SMALL AGRICULTURAL HOLDINGS ZONE - 15 ha
A-2	LARGE AGRICULTURAL HOLDINGS ZONE - 65 ha
CR	COUNTRY RESIDENTIAL ZONE - 1.8 ha
RR-1	RURAL RESIDENTIAL ZONE - 1.8 ha
RR-2	RURAL RESIDENTIAL ZONE - 4.0 ha
RR-4	SMALL HOLDINGS ZONE - 8.0 ha
R-1	RESIDENTIAL ZONE
R-2	SEMI-RURAL RESIDENTIAL ZONE
R-3	MOBILE HOME PARK RESIDENTIAL ZONE
MU-R	MIXED USE - RESIDENTIAL ZONE
C-1	LOCAL COMMERCIAL ZONE
C-2	HIGHWAY COMMERCIAL ZONE
C-3	RECREATIONAL COMMERCIAL ZONE
M-1	LIGHT INDUSTRIAL ZONE
M-2	GENERAL INDUSTRIAL ZONE
P-1	PUBLIC SERVICE ZONE
P-2	INSTITUTIONAL ZONE

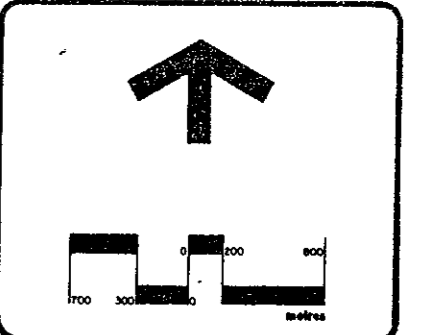

Amended to:
 Bylaw No. 1985

Peace River Liard
 Regional District

SCHEDULE B
ZONING BYLAW No. 506 1988
OFFICIAL ZONING MAP
CHETWYND RURAL AREA

This is Schedule B of Bylaw No. 506, 1988, being the Official Zoning Map Referred to in Section 5.2 of the said Bylaw and Forming Part of the Peace River-Liard Regional District Zoning Bylaw No. 506, 1988.

[Signature]
 SECRETARY

Map 7
Willow Flats

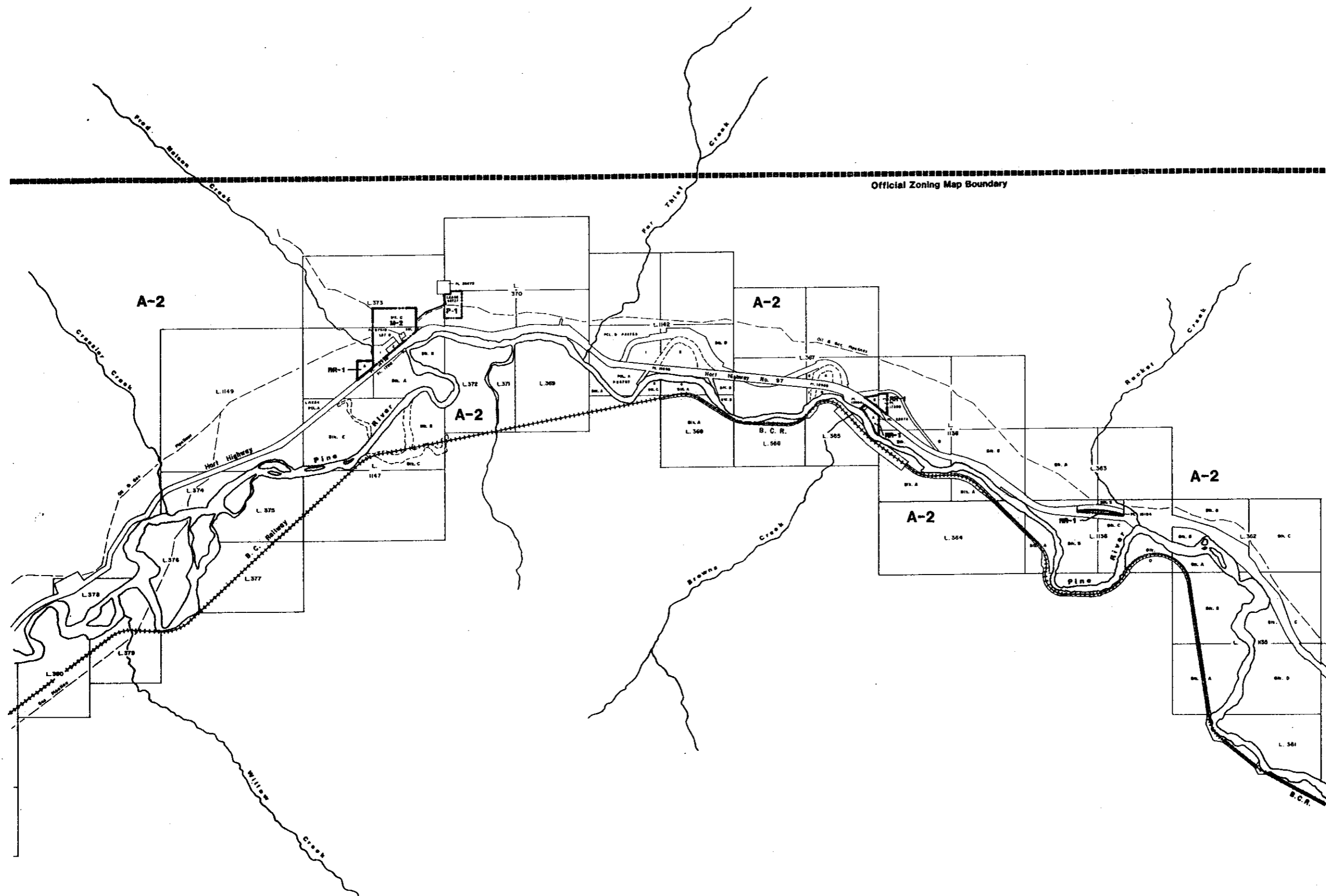

ZONES

Convenient Reference	Correct Name
A-1	SMALL AGRICULTURAL HOLDINGS ZONE - 15 ha
A-2	LARGE AGRICULTURAL HOLDINGS ZONE - 63 ha
CR	COUNTRY RESIDENTIAL ZONE - 1.8 ha
RR-1	RURAL RESIDENTIAL ZONE - 1.8 ha
RR-2	RURAL RESIDENTIAL ZONE - 4.0 ha
RR-4	SMALL HOLDINGS ZONE - 8.0 ha
R-1	RESIDENTIAL ZONE
R-2	SEMI-RURAL RESIDENTIAL ZONE
R-3	MOBILE HOME PARK RESIDENTIAL ZONE
MU-R	MIXED USE - RESIDENTIAL ZONE
C-1	LOCAL COMMERCIAL ZONE
C-2	HIGHWAY COMMERCIAL ZONE
C-3	RECREATIONAL COMMERCIAL ZONE
M-1	LIGHT INDUSTRIAL ZONE
M-2	GENERAL INDUSTRIAL ZONE
P-1	PUBLIC SERVICE ZONE
P-2	INSTITUTIONAL ZONE
▬▬▬	ZONING MAP BOUNDARY

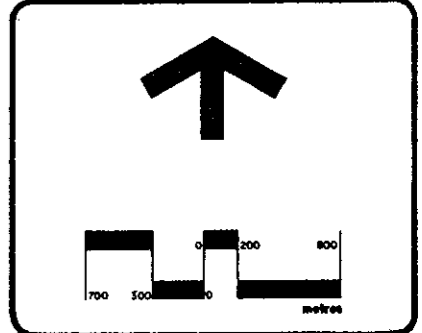

Amended to:
 Bylaw No. 1985

Peace River Liard Regional District

SCHEDULE B
ZONING BYLAW No. 506,1988
OFFICIAL ZONING MAP
CHETWYND RURAL AREA

This is Schedule B of Bylaw No. 506, 1988, Being the Official Zoning Map, Enacted in Section 22 of the Peace River and Forming Part of the Peace River-Liard Regional District Zoning Bylaw No. 506, 1988.

[Signature]
 SECRETARY

Map 8
East Pine

ZONES

Convenient Reference	Correct Name
A-1	SMALL AGRICULTURAL HOLDINGS ZONE - 10 ha
A-2	LARGE AGRICULTURAL HOLDINGS ZONE - 63 ha
CR	COUNTRY RESIDENTIAL ZONE - 1.8 ha
RR-1	RURAL RESIDENTIAL ZONE - 1.8 ha
RR-2	RURAL RESIDENTIAL ZONE - 4.0 ha
RR-4	SMALL HOLDINGS ZONE - 8.0 ha
R-1	RESIDENTIAL ZONE
R-2	SEMI-RURAL RESIDENTIAL ZONE
R-3	MOBILE HOME PARK RESIDENTIAL ZONE
MU-R	MIXED USE - RESIDENTIAL ZONE
C-1	LOCAL COMMERCIAL ZONE
C-2	HIGHWAY COMMERCIAL ZONE
C-5	RECREATIONAL COMMERCIAL ZONE
M-1	LIGHT INDUSTRIAL ZONE
M-2	GENERAL INDUSTRIAL ZONE
P-1	PUBLIC SERVICE ZONE
P-2	INSTITUTIONAL ZONE
-----	ZONING MAP BOUNDARY

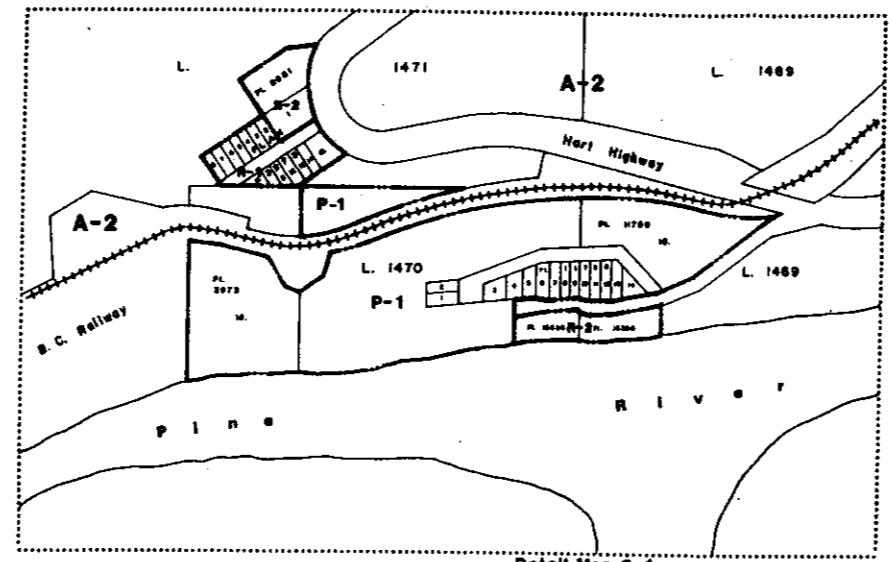

Detail Map 8-1 scale 1:5,000

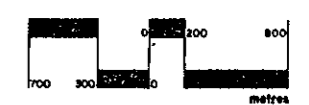
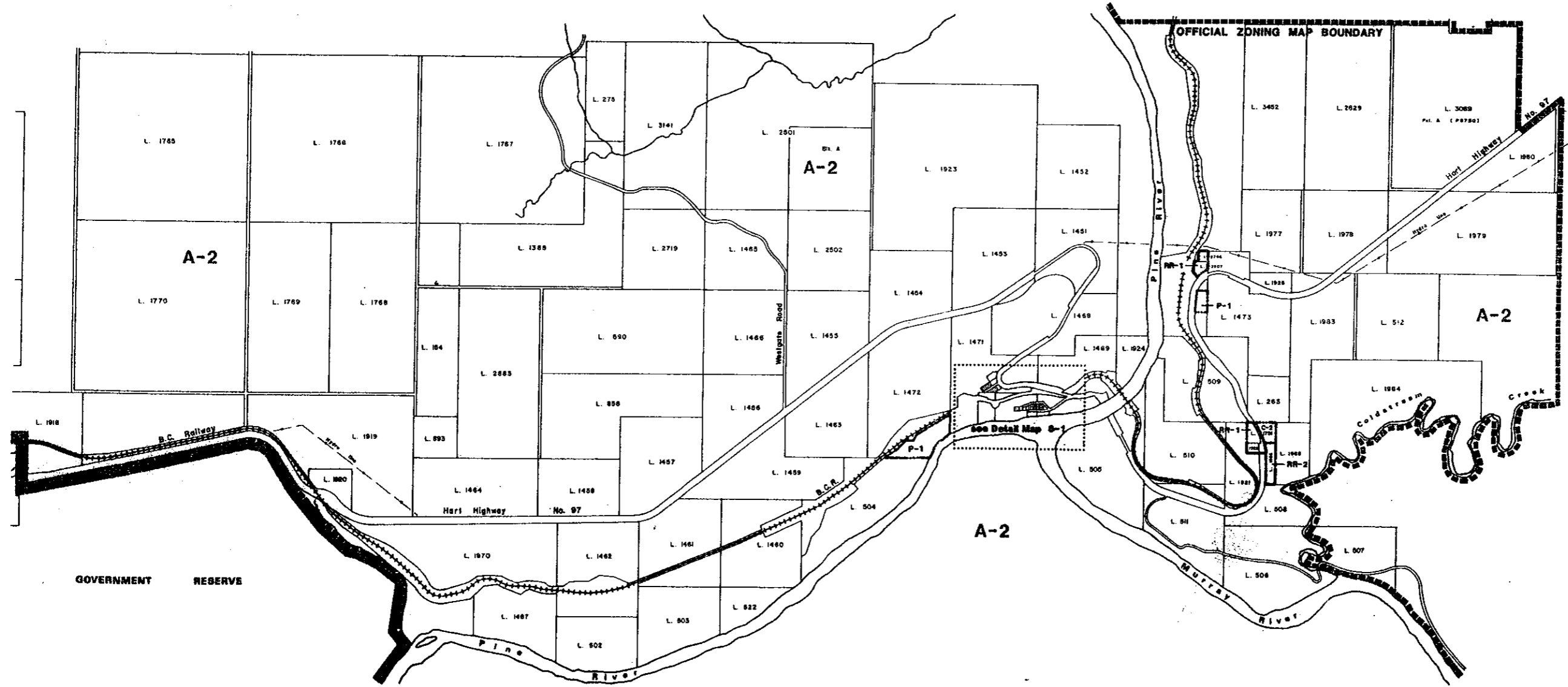

Amended by
 Bylaw No. , 1988

